

# SolaBrite Plus

Refer to product table below for applicable product codes covered by this document

Issue **A**

## Product Type & Application

Bradford Ventilation SolaBrite Plus is a tubular skylight ventilator designed to bring natural light to a living space with integrated vent holes to reduce condensation and heat build-up within the skylight.

## Compliance with the NCC

There are no relevant clauses within the NCC for this product to comply with.

## Evidence of Suitability

There are no relevant clauses within the NCC to show compliance with.

## Conditions of Storage, Use & Maintenance

- Store in the original packaging in a cool and dry area.
- The diffuser must be cleaned regularly to ensure maximum amount of light entering the living space.
- Do not attempt to repair – contact Bradford Ventilation for service advice.

**Refer to the product warranty at [bradfordventilation.com.au](http://bradfordventilation.com.au) for more information.**

## Limitations of Use

- The SolaBrite Plus is designed for Class 1 and Class 10a building roofs in non-cyclonic regions.
- Do not use for exhausting hazardous, abrasive, acidic and alkaline vapour or areas containing explosive or corrosive materials.
- This product is not suitable for use in Bush Fire BAL-12.5 to BAL-40 or FZ rated areas.
- The product is suitable for roof pitches 5° to 35°.
- **IMPORTANT - Do Not Modify This Product:** Performance and safety are only achieved by the product or configuration listed in this PTS.

## Specific Design or Installation Instructions

- This product requires specific areas to be sealed against water entry and other areas to be left unsealed to allow internal condensation drainage – refer to the installation guide for details.
- For optimal performance install SolarBrite Plus on the northern side of the roof, in a location with clear sunlight that is not shaded.
- Incoming light levels may be reduced when the product is installed with an orientation away from north and with an elevation outside 20°-35° roof pitch.
- The flexible tubing is most effective in reflecting light when fixed in a straight line but it can be bent to reach difficult areas - note that the more bends in the tube will progressively reduce the proportion of reflected light.
- Installation must be in accordance with the SolaBrite Installation Instruction.

**For general installation guidance refer to the product installation guide at [www.bradfordventilation.com.au](http://www.bradfordventilation.com.au)**

## SolaBrite Plus

### Applicable Product Codes (SKU)

Colour	Corrugated Roof		Metal Roof		Tile Roof	
	Custom	Zinc	Custom	Zinc	Custom	Zinc
SolaBrite Plus 350mm	61437	61428	61436	61427	61435	61426
SolaBrite Plus 400mm	61440	61431	61439	61430	61438	61429
SolaBrite Plus 500mm	61443	61434	61442	61433	61441	61432

### Product Dimensions (in mm)

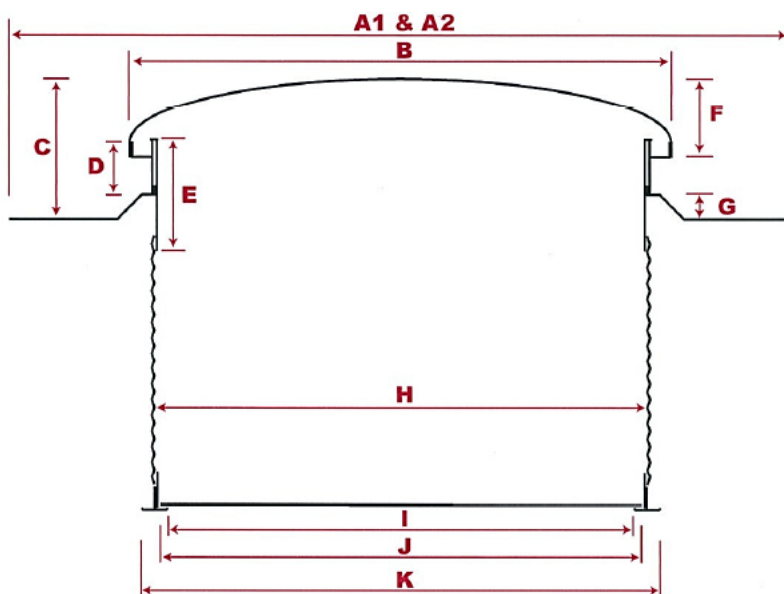

Item	SolaBrite Plus 350mm	SolaBrite Plus 400mm	SolaBrite Plus 500mm
A1 (L)	850	850	850
A2 (W)	750	750	750
B	503	503	631
C	190	190	195
D	69	67	70
E	144	144	144
F	125	125	118
G	20	25	25
H	356	406	506
I	321	365	465
J	341	391	491
K	411	455	560

## SolaBrite Plus

### Product Specification

Item Description	Material
Dome	High Impact Acrylic
Flashing/Soaker	Zinc
Reflector Plate (Throat)	Stainless Steel (Polished)
Duct	Flexible Reflective Duct (2m)
Ceiling Frame	Aluminium (White Powder Coated)

### Product Illustration

